

**MATERIAL**

Aluminium, epoxy resin coating, black or light grey colour, matte finish.

**CENTRE CAP**

Technopolymer black or light grey colour.

**STANDARD EXECUTIONS**

- **GN 559-A:** closed shape for mounting with threaded blind holes.
- **GN 559-B:** open shape for mounting with threaded blind holes.
- **GN 559-C:** open shape for mounting with pass-through holes for M8 cylindrical head screws with hexagon socket, with closing cap.

Colour index:

- **SW:** RAL 9005 black colour.
- **SR:** RAL 9006 grey colour.

**ERGONOMY AND DESIGN**

GN 559 handles are characterized by an ergonomic design able to achieve the grip with a precise orientation.

The holes for the fixing screws of GN 559-C execution are closed in the appropriate housing with a cap to be fitted after the handle is assembled.

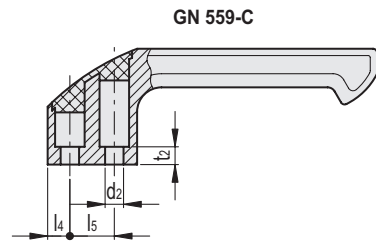
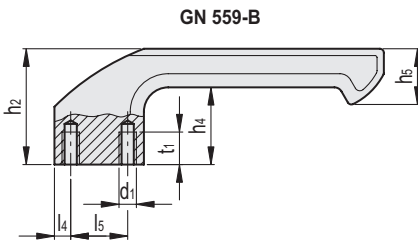
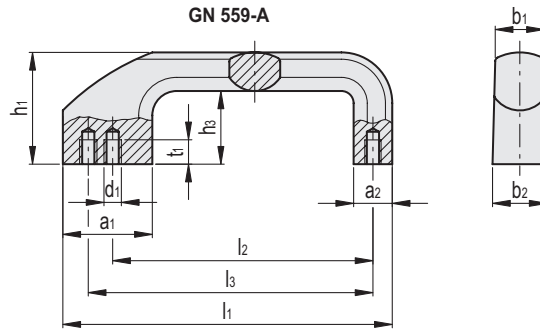
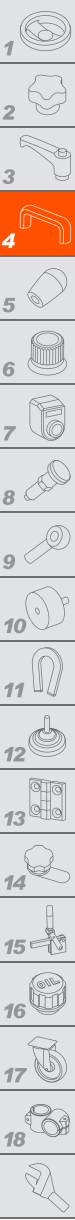

Conversion Table	
1 mm = 0.039 inch	
l1	
mm	inch
162	6.38

**GN 559-A**

METRIC

Code	Description	l1±0.25	l2	l3	d1	b1	b2	a1	a2	h1	h3	t1 min	⚖
GN.26631	GN 559-162-A-SW	162	128	140±0.2	M8	25	28	38	19	55	36	12	262
GN.26629	GN 559-162-A-SR	162	128	140±0.2	M8	25	28	38	19	55	36	12	262

**GN 559-B**

Code	Description	l1±0.25	d1	b1	b2	a1	h2	h4	h5	l4	l5	t1 min	⚖
GN.26632	GN 559-162-B-SW	162	M8	25	28	38	57	38	28	8	22	16	248
GN.26630	GN 559-162-B-SR	162	M8	25	28	38	57	38	28	8	22	16	248

**GN 559-C**

Code	Description	l1±0.25	d2	b1	b2	a1	h2	h4	h5	l4	l5	t2	⚖
GN.26633	GN 559-162-C-SR	162	8.3	25	28	40	57	38	28	10	20	8	222
GN.26634	GN 559-162-C-SW	162	8.3	25	28	40	57	38	28	10	20	8	222